

# ANTHONY JAMES MANSEY

Residential Sales & Lettings



## Spencer Road

Isleworth, TW7 4BN

**£265,000**

Leasehold

Council Tax Band C

Situated in a residential cul-de-sac and within its own communal gardens. A purpose built ground floor apartment with entry phone system. This is a very decent sized property with spacious accommodation and comprising entrance hallway, modern fitted kitchen, large bright and airy reception room, double bedroom and bathroom suite with separate WC. This home would make an ideal first time purchase. There is no stamp duty on this property for first time buyers. This apartment is being sold chain free and is available now to view. Features include double glazed windows and a garage in a separate block. Osterley tube station is on the Piccadilly line and serves Heathrow and Central London. To view contact the owners sole agents.

Lease Details: 199 years from 25th December 1972 146 years remaining  
Service Charge: £1,728.58 per annum approximately.

- A Purpose Built Ground Floor Apartment
- Spacious and Extremely Light Reception Room
- Modern Kitchen with Fitted Oven, Hob & Extractor Fan
- Set within Communal Grounds
- Double Bedroom
- Bathroom Suite with Separate WC
- Double Glazed Windows
- Ideal First Time Purchase or Buy to Let Investment
- Garage in Block
- No Stamp Duty on this Home for First Time Buyers

### Viewing

Please contact our Sales Office on 020 8847 0488 if you wish to arrange a viewing appointment for this property or require further information.



1



1



1

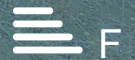

F



Floor Plan

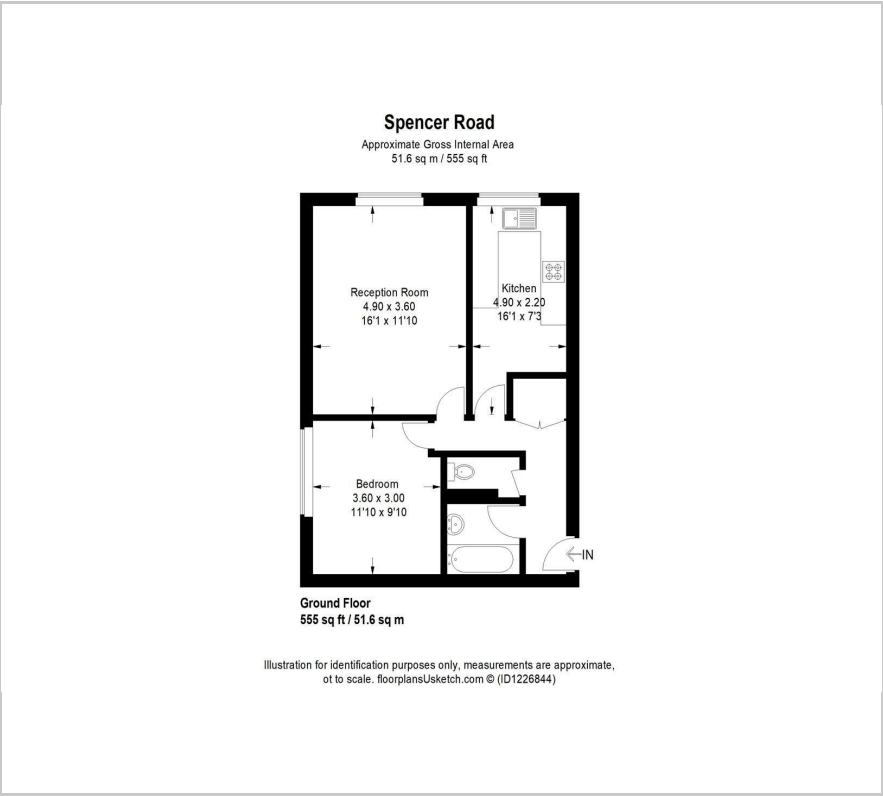

Area Map



Energy Efficiency Graph

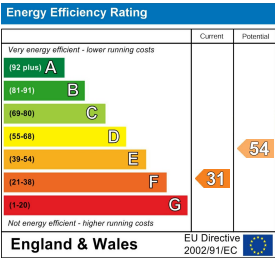

These particulars, whilst believed to be accurate are set out as a general outline only for guidance and do not constitute any part of an offer or contract. Intending purchasers should not rely on them as statements of representation of fact, but must satisfy themselves by inspection or otherwise as to their accuracy. No person in this firms employment has the authority to make or give any representation or warranty in respect of the property.